

DS-PDEBP2-EG2-WB Wireless Portable Emergency Button Quick Start Guide

ENGLISH

- 1. APPEARANCE 1. Lanyard 2. Indicator 3. Panic Button
2. ENROLLMENT
3. TEST 1. Button activated 2. Alarm Received
4. REPLACE BATTERY

User Manual Scan the QR code for more information and operation help.

Table with specifications: LED indicators (Red or Green), IP rating (IP66), Operating temperature (-10°C to 55°C), Storage temperature (-20°C to 60°C), Weight (13.5g), Transmission frequency (433 MHz), Battery (CR2032 x 1), Standard battery life (3 years), PS type (Type C), Low voltage level (2.35 V), Consumption (Quiescent Current: 1.47 uA), Classification (Portable), ACE type (Type B).

Note: when the low voltage message appears there will be at least 30 days of use.

©2021 Hangzhou Hikvision Digital Technology Co., Ltd. All rights reserved.
This manual contains instructions for using your emergency button. Please read and follow all other information hereafter for use for the maximum benefit of the product.

WARRANTY CAUTION: Replacement of a battery with an incorrect type can damage the equipment. In the case of some lithium battery packs, replacement of a battery may result in an explosion or fire.

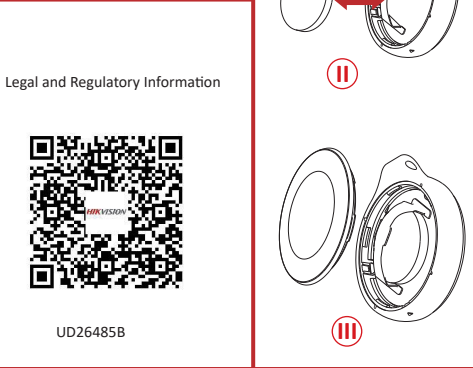
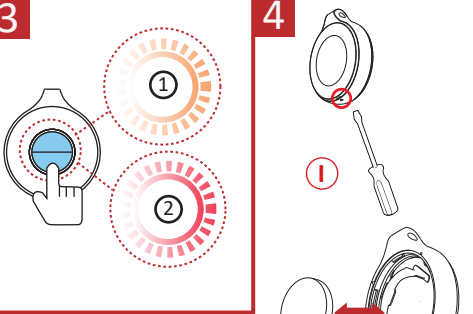
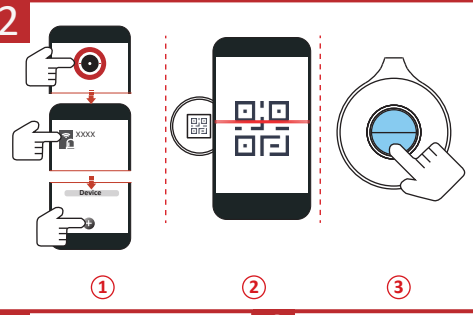
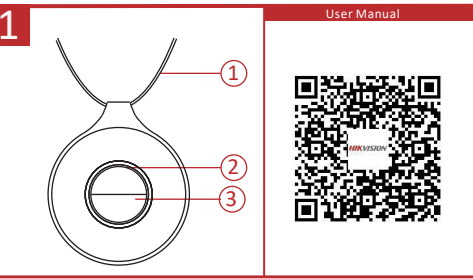

Legal and Regulatory Information



UD26485B

Device Serial No.



ESPAÑOL

- 1. APARIENCIA 1. Cordón de seguridad 2. Piloto 3. Botón de pánico
2. REGISTRO
3. PRUEBA 1. Botón activado 2. Alarma recibida
4. REEMPLAZO DE LA BATERÍA

Manual de usuario Escanee el código QR para obtener más información y ayuda sobre el funcionamiento.

Table with specifications: Indicadores led (Rojo o verde), IP rating (IP66), Operating temperature (-10°C to 55°C), Storage temperature (-20°C to 60°C), Weight (13.5g), Transmission frequency (433 MHz), Battery (CR2032 x 1), Standard battery life (3 años), PS type (Tipo C), Low voltage level (2.35 V), Consumption (Corriente de reposo: 1.47 uA), Classification (Portable), ACE type (Tipo B).

Nota: La aparición del mensaje de baja tensión indica que restan al menos 30 días de uso.

SRPSKI

- 1. IZGLLED 1. Uzica 2. Indikator 3. Dugme za uzbunu
2. UVRŠTAVANJE
3. TEST 1. Dugme aktivirano 2. Alarm primljen
4. ZAMENJA BATERIJE

Korisnički priručnik Skenirajte QR kod za više informacija i pomoć prilikom rada.

Table with specifications: LED indicators (Crveno ili zeleno), IP rating (IP66), Operating temperature (Od -10°C do 55°C), Storage temperature (Od -20°C do 60°C), Weight (13,5 g), Transmission frequency (433 MHz), Battery (CR2032 x 1), Standard battery life (3 godine), PS type (Tip C), Low voltage level (Nivo niskog napona), Consumption (Struja mirovanja: 1,47 uA), Classification (Klasifikacija), ACE type (Tip B).

Napomena: kad se pojavi poruka za nizak napon, ostaje bar 30 dana korišćenja.

PORTUGUÊS (BRASIL)

- 1. APRESENTAÇÃO 1. Cordão 2. Indicador 3. Botão de pânico
2. REGISTRO
3. TESTE 1. Botão ativado 2. Alarma recebido
4. TROCA DA BATERIA

Manual do usuário Leia o código QR para mais informações e ajuda na operação.

Table with specifications: Indicadores LED (Vermelho ou verde), IP rating (IP66), Operating temperature (-10°C to 55°C), Storage temperature (-20°C to 60°C), Weight (13,5 g), Transmission frequency (433 MHz), Battery (CR2032 x 1), Standard battery life (3 anos), PS type (Tipo C), Low voltage level (Nível de baixa tensão), Consumption (Corrente quando inativo: 1,47 uA), Classification (Classificação), ACE type (Tipo B).

Nota: quando a mensagem de baixa tensão aparecer, haverá pelo menos 30 dias de uso.

HEBREW

- 1. תרשום רכיבים 1. חרוך 2. מחוון 3. לחצן מזוקה
2. הרשמה
3. טסט 1. מופעל באמצעות לחצן 2. ותקבלה אזעקה
4. החלף סוללה

מדריך למשתמש סרוק קוד QR למידע נוסף ועזרה בתפעול.

Table with specifications: LED indicators (אדום או ירוק), IP rating (IP66), Operating temperature (על -10°C עד 55°C), Storage temperature (על -20°C עד 60°C), Weight (13,5 ג'), Transmission frequency (433 MHz), Battery (CR2032 x 1), Standard battery life (3 שנה), PS type (סוג PS), Low voltage level (רמת תחת מתח), Consumption (זרם במחמת: 1,47uA), Classification (קטגוריה), ACE type (סוג ACE).

הערה: כאשר הסימן למתח נמוך מופיע יחדיו עוד 30 ימי תימשך הפחוט.

SLOVENŠČINA

- 1. PREGLED NAPRAVE 1. Vrvice 2. Indikator 3. Gumb za paniko
2. VPIS
3. PREIZKUS 1. Gumb aktiviran 2. Prejet alarm
4. MENJAJA BATERIJE

Uporabniški priročnik Če želite več informacij in pomoč pri delovanju, optično preberite kod QR.

Table with specifications: Indikatorji LED (Rdeči ali zeleni), IP rating (IP66), Operating temperature (-10°C to 55°C), Storage temperature (-20°C to 60°C), Weight (13,5g), Transmission frequency (433 MHz), Battery (CR2032 x 1), Standard battery life (3 leta), PS type (Tip C), Low voltage level (Največ nizke napetosti), Consumption (Mirovni tok: 1,47 uA), Classification (Klasifikacija), ACE type (Tip B).

Opomba: ko se prikaže sporočilo o nizki napetosti, lahko uporabljate še vsaj 30 dni.

မြန်မာ

- 1. အပူပေး ဝါယာရိပ်ကိရိယာ 1. ဝါယာရိပ် 2. ဝါယာရိပ် 3. အပူပေး ဝါယာရိပ်
2. ဝါယာရိပ်
3. ဝါယာရိပ်
4. ဝါယာရိပ်

အပူပေး ဝါယာရိပ် အသုံးပြုမှု မှတ်တမ်း ဝါယာရိပ် အသုံးပြုမှု မှတ်တမ်း QR ကုဒ်ကို စာဖတ်ဆောင်ရွက်ပါ။

Table with specifications: LED indicators (အနီ သို့မဟုတ် အစိမ်းရောင်), IP rating (IP66), Operating temperature (-10°C to 55°C), Storage temperature (-20°C to 60°C), Weight (13.5g), Transmission frequency (433 MHz), Battery (CR2032 x 1), Standard battery life (3 နှစ်), PS type (PS အမျိုးအစား C), Low voltage level (နိမ့်ဆုံး ဝါယာရိပ်: 1.47 uA), Consumption (အပူပေး ဝါယာရိပ် အသုံးပြုမှု: 1.47 uA), Classification (အမျိုးအစား B), ACE type (ACE အမျိုးအစား B).

မှတ်ချက်: ဝါယာရိပ် အသုံးပြုမှု မှတ်တမ်း ဝါယာရိပ် အသုံးပြုမှု မှတ်တမ်း QR ကုဒ်ကို စာဖတ်ဆောင်ရွက်ပါ။

